



Vestil Manufacturing Co.

2999 North Wayne Street, P.O. Box 507, Angola, IN 46703

Telephone: (260) 665-7586 -or- Toll Free (800) 348-0868

Fax: (260) 665-1339

Web: www.vestil.com e-mail: info@vestil.com

ALUMINUM DOCK PLATES

AHTD-SERIES & TAS-SERIES



Receiving Instructions

After delivery, remove the packaging from the product. Inspect the product closely to determine whether it sustained damage during transport. If damage is discovered, record a complete description of it on the bill of lading. If the product is undamaged, discard the packaging.

NOTE: The end-user is solely responsible for confirming that product design, use, and maintenance comply with laws, regulations, codes, and mandatory standards applied where the product is used.

Technical Service & Replacement Parts

For answers to questions not addressed in these instructions and to order replacement parts, labels, and accessories, call our Technical Service and Parts Department at (260) 665-7586. The Department can also be contacted online at <https://www.vestil.com/page-parts-request.php>.

Electronic Copies of Instruction Manuals

Additional copies of this instruction manual may be downloaded from <https://www.vestil.com/page-manuals.php>.

Table of Contents

	Page
I. Specifications.....	2
II. Signal Words.....	3
III. Safety Instructions.....	3
IV. Assembling a Dockplate.....	4
V. Using a Dockplate.....	4 - 5
VI. Positioning and Using Your Dockplate.....	5 - 6
VII. Record of Satisfactory Condition.....	6
VIII. Inspecting & Maintaining the Dockplate.....	6
IX. Exploded Views and Bills of Materials.....	7, 8, 9
X. Labeling Diagram.....	10
XI. Limited Warranty.....	11

I. SPECIFICATIONS

Documents that provide specifications for each model of dockplate are available online to anyone who visits Vestil's website. Specifications include dimensions, net weight, and capacity information. Navigate to <https://www.vestil.com/product.php?FID=35> for AHTD series, or to <https://www.vestil.com/product.php?FID=34> for TAS-series dockboards. Scroll to the Product Specifications Table portion of the page. Find the entry for the dockplate you purchased and click the button in the "PDF" column that looks like a pencil inside a blue-bordered box. A PDF file will open. This file is the specifications document. Print a copy of the document and keep it with your copy of this manual. The following is an exemplar specifications document for model AHTD-3036.

ALUMINUM HAND TRUCK DOCKBOARDS - AHTD-3036		APPROX WEIGHT: 33.54 lbs. DOES NOT INCLUDE WEIGHT OF POWER OR PACKAGING!!!																															
*** ANY ADDITIONS, DELETIONS, OR OMISSIONS MUST BE CORRECTED ON THIS DRAWING AS THIS DRAWING WILL BE CONSIDERED ALL INCLUSIVE *** ALL GRAPHICS PROVIDED ARE FOR REFERENCE ONLY. IF CERTAIN DIMENSIONS ARE CRITICAL PLEASE VERIFY THOSE DIMENSIONS WITH YOUR SALESPERSON																																	
<p>Top View Dimensions: Overall Width: 31 1/4", Overall Length: 35 7/8", Usable Width: 28", Bracket Leg Length: 5". Side View Dimensions: Max Height Differential: 5", Locking Leg Height: 9 1/4", Locking Leg Length: 7 3/16".</p>																																	
STANDARD FEATURES MODEL NUMBER: AHTD-3036 CAPACITY: 800 LBS OVERALL WIDTH: 31 1/4" OVERALL LENGTH: 35 7/8" MAX HEIGHT: DIFFERENTIAL: 5" USABLE WIDTH: 28" BRACKET LEG LENGTH: 5" EQUIPPED WITH BOLT ON LOCKING LEGS FULL LENGTH ALUMINUM CURBS WELDED ALUMINUM DIAMOND TREAD SURFACE AND BEVELED EDGES		DIMENSION TOLERANCE $\pm 1/4"$ I, THE UNDERSIGNED, AGREE THAT THE PRODUCT AS REPRESENTED SATISFIES DESIGN AND DIMENSION REQUIREMENTS. I ALSO ACKNOWLEDGE MY DUTY TO CONFIRM PRODUCT AND INSTALLATION COMPLIANCE WITH ALL APPLICABLE FEDERAL, STATE AND LOCAL REGULATIONS AND STANDARDS. ANY MODIFIED UNITS ARE NON-RETURNABLE <input type="checkbox"/> As drawn <input type="checkbox"/> As marked Signed: _____ Date: _____ Printed Name: _____ LEAD TIME WILL START UPON RECEIPT OF SIGNED APPROVAL DRAWING																															
SPECIAL FEATURES NONE		<table border="1"> <tr> <td colspan="2">FOR INTERNAL USE ONLY PROJECT SIGN OFF</td> <td colspan="2">DISTRIBUTOR'S NAME: VESTIL MANUFACTURING</td> <td colspan="2">P.O.# X</td> </tr> <tr> <td>SALES</td> <td></td> <td colspan="2">DRAWN BY: ADL</td> <td>DATE: 1/3/06</td> <td>W.O.# X</td> </tr> <tr> <td>ENG.</td> <td></td> <td colspan="2">REFERENCE: X</td> <td>SCALE: 1:12</td> <td>SALES: X</td> </tr> <tr> <td>FAB.</td> <td></td> <td colspan="2">QUOTED LEAD TIME: X</td> <td>QUOTE # X</td> <td>FILE NAME: 11-007-010</td> </tr> <tr> <td>POWER</td> <td></td> <td colspan="4"></td> </tr> </table>		FOR INTERNAL USE ONLY PROJECT SIGN OFF		DISTRIBUTOR'S NAME: VESTIL MANUFACTURING		P.O.# X		SALES		DRAWN BY: ADL		DATE: 1/3/06	W.O.# X	ENG.		REFERENCE: X		SCALE: 1:12	SALES: X	FAB.		QUOTED LEAD TIME: X		QUOTE # X	FILE NAME: 11-007-010	POWER					
FOR INTERNAL USE ONLY PROJECT SIGN OFF		DISTRIBUTOR'S NAME: VESTIL MANUFACTURING		P.O.# X																													
SALES		DRAWN BY: ADL		DATE: 1/3/06	W.O.# X																												
ENG.		REFERENCE: X		SCALE: 1:12	SALES: X																												
FAB.		QUOTED LEAD TIME: X		QUOTE # X	FILE NAME: 11-007-010																												
POWER																																	



Pounds to kilograms conversion: 2.2LB. = 1KG

Uniform capacity = Maximum evenly distributed weight the dockplate can support.

All models comply with OSHA 1910.26 and ANSI MH30.2 standards for portable dockboards.

II. SIGNAL WORDS

SIGNAL WORDS in this manual are meant to draw the reader's attention to important safety-related messages.

 DANGER	Identifies a hazardous situation which, if not avoided, WILL result in DEATH or SERIOUS INJURY . Use of this signal word is limited to the most extreme situations.
 WARNING	Identifies a hazardous situation which, if not avoided, COULD result in DEATH or SERIOUS INJURY .
 CAUTION	Indicates a hazardous situation which, if not avoided, COULD result in MINOR or MODERATE injury.
NOTICE	Identifies practices likely to result in product/property damage, such as operation that might damage the product.

III. SAFETY INSTRUCTIONS

Vestil strives to identify foreseeable hazards associated with the use of its products. However, no manual can address every conceivable risk. To minimize the likelihood of being injured as a result of using this device, inspect and maintain the product as instructed in section VIII. INSPECTING & MAINTAINING... Apply good judgment when using this device.

WARNING

Risks of serious personal injuries or death.

- Read this manual in its entirety before assembling, using, inspecting or servicing the product. A copy of this manual should always be available to any person who assembles, installs, uses, inspects, or maintains this dockboard.
- DO NOT use this dockboard with powered equipment such as fork trucks on AHTD series models; AHTD is designed only for foot traffic or two-wheeled hand trucks. TSA series are suitable for fork trucks, but when using three-wheeled fork trucks, select a model with capacity at least four times the lifting capacity of the fork truck.
- DO NOT exceed the maximum rated load.
- Inspect the dockboard as instructed in part VIII. [INSPECTING & MAINTAINING YOUR DOCKBOARD](#) on p. 6. Remove the dockboard from service if an inspection reveals changes from SATISFACTORY CONDITION. DO NOT use the dockboard until it is restored to satisfactory condition. ONLY use manufacturer-approved replacement parts to repair your dockboard.
- DO NOT use a damaged dockboard. ONLY use a dockboard that is in satisfactory condition. See VII. [RECORD OF SATISFACTORY CONDITION](#) on p. 6; also see INSPECTING AND MAINTAINING YOUR DOCKBOARD on p. 6.
- ONLY qualified maintenance personnel should maintain and repair this product. An improperly maintained dockboard could become unsafe to use.
- ONLY use a dockboard on structurally sound loading dock surfaces (e.g. concrete, steel) that are even & level. DO NOT use this dockboard to bridge uneven or sloping surfaces.
- DO NOT use a dockboard unless all labels are in place, undamaged, and easily readable from a reasonable, safe distance. DO NOT remove or obscure labels.
- DO NOT modify this dockboard in any way. Modifications automatically void the [LIMITED WARRANTY](#) (see part XI. on p. 11) and might make the dockboard unsafe to use.
- Ensure the dockboard is properly positioned and legs are locked before use. The lip must rest securely on the trailer bed, extending at least 4-6 inches.
- Comply with OSHA 1910.26 and ANSI MH30.2 standards for portable dockboards.
- Practice proper lifting techniques when manually handling dockboards. Use hand holds or lifting chains/loops.

NOTICE

Proper use, maintenance, and storage are essential for this product to function properly.

- Always use this product in accordance with the instructions in this manual and consistent with any training relevant to machines, devices, etc. used in conjunction with this product.
- Keep the product clean & dry. Store it in an indoor location.

IV. ASSEMBLING THE DOCKPLATE (AHTD SERIES)

A. AHTD-series: Refer to section IX.A. [AHTD EXPLODED VIEW](#) on page 7. AHTD series products can be configured for use either as **A) dockplates**, or **B) ramps**, depending on how the leg brackets are attached: **A) long side down = dockplate**; **B) short side down = ramp**. Align the bolt holes in the left and right leg brackets with the bolt holes in your dockplate. Then, install carriage bolts (part no. 21359) through the bolt holes in the dockplate. Put a lock washer (33622) onto the end of each bolt. Then, securely tighten a hex nut (36106) on each bolt.

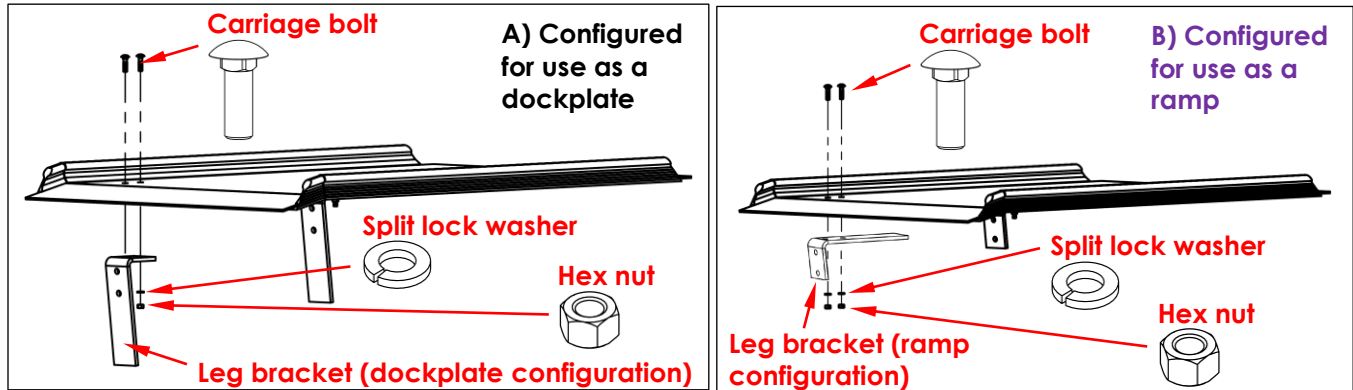

B. TAS-series: Refer to section IX.B. [TAS EXPLODED VIEW](#) on page 8.

1. Install leg brackets: Align the bolt holes in the left and right leg brackets with the bolt holes in your dockplate. Then, install carriage bolts (part no. 20268) through the bolt holes in the dockplate. Put a lock washer (33626) onto the end of each bolt. Then, securely tighten a hex nut (36110) on each bolt.
2. Install burbs: Align bolt bolts in the curbs with bolt holes in the dockplate. Then, install carriage bolts up through the aligned bolt holes, apply a lock washer to each bolt followed by a hex nut. Tighten nuts.

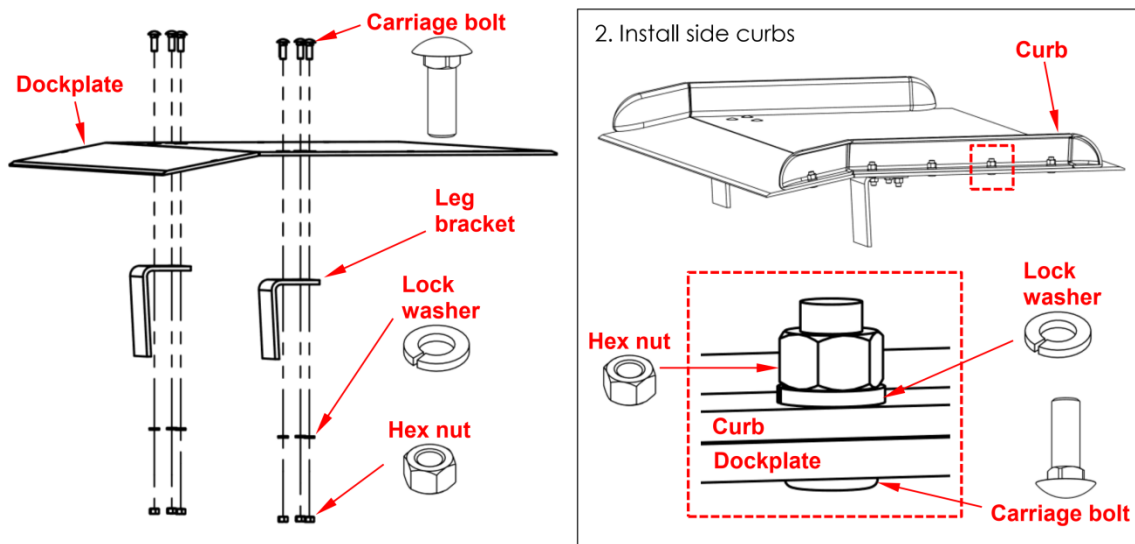

V. USING A DOCKPLATE

Personnel with experience loading and unloading trailers should determine the appropriate use of dockplates on a case-by-case basis, including the optimal positioning. Compelling reasons to use dockplates include, but are not limited to:

- Bridging gaps between a loading dock & a trailer bed.
- Providing a strong, skid-resistant transition for hand trucks or pallet jacks.
- Enhancing safety during manual material handling operations.

Dockplates are portable and feature two leg brackets for secure placement. Each trailer should be parked at a loading dock with wheels chocked to prevent movement. Dockplates are not designed for powered fork trucks and must not be used with them. NEVER use a

dockplate unless it is structurally sound, stable (doesn't wobble or slide), and both legs extend into the gap between the loading dock and trailer bed.

Before using a dockplate, inspect it as described in section VIII. [INSPECTING & MAINTAINING THE DOCKPLATE](#) section on p. 6. Confirm the dockplate is in satisfactory condition before use.

Be aware of your dockplate's load rating. Load ratings (capacities) are provided in on-product labeling as well as in section 1. [SPECIFICATIONS](#) section on p. 2. See section X. [LABELING DIAGRAM](#) on p. 10. Uniform capacity = maximum evenly distributed weight the dockplate can support. DO NOT exceed the load rating!

Before installing a dockplate:

1. Immobilize the trailer with wheel chocks.
2. The surface on which the dockplate will be used must be even, level, intact concrete or similar. Asphalt is not recommended as it may compress.
3. Confirm that the dock and trailer bed are structurally sound, even, and level where the dockplate will contact them. Do not use the dockplate if either surface is unsound.
4. Ensure the height differential between the loading dock and trailer bed does not exceed the recommended limit for your dockplate. All model names include at least 4-digits (e.g. TAS-10-6036 & AHTD-3036). The maximum height difference between the dock and the trailer bed depends on the last 2 digits of your model name as indicated in the following table:

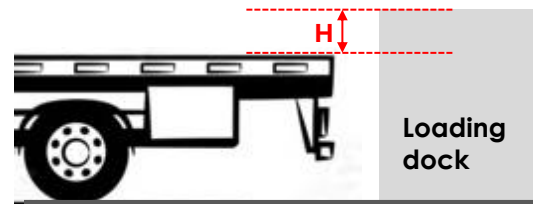

Last 2 Digits of Model Name						
36	42	48	54	60	72	96
5"	6"	7"	8"	10"	12"	15"

Max. height difference (H)

VI. POSITIONING AND USING YOUR DOCKPLATE

1. Confirm the trailer is chocked and stable.
2. All TAS and AHTD series dockplates include bolt-on leg brackets and either bolt-on (TAS) or welded (AHTD) side curbs. Dockplates can be carried by grasping one of the side curbs, or be transported. The legs of TAS-series dockplates are different lengths to facilitate entry of forklift tines underneath them.
3. Each dockplate includes an 11-degree bend. This bend allows a dockplate to provide a stable transition between surfaces of differing heights.
4. Position the dockplate to span the gap between your loading dock and trailer bed.
 - a. The short side of the dockplate should be placed on the *higher surface* and the longer side on the lower surface. In the diagram to the right, the loading dock is higher than the bed of the trailer, so the short side of the dockplate rests on the loading dock.
 - b. Confirm both leg brackets extend into the gap between the dock and the trailer bed and **below the level of the lower surface** (trailer bed in the diagram). This is critical to secure the dockplate in place during use.
 - c. Confirm that both ends of the dockplate overlap the vehicle/trailer bed and the loading dock by at least 4 inches ($\geq 4"$).

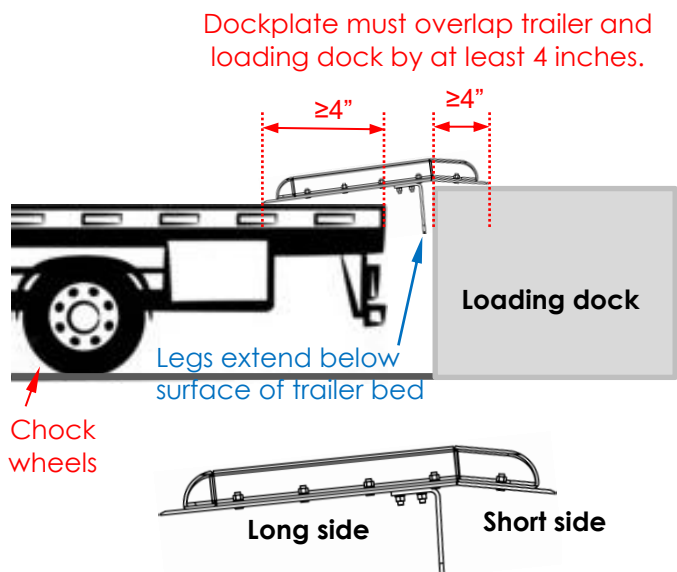

- d. Confirm the dockplate is stable before using/traversing it.
- e. Do not use if unstable or if height differential exceeds design limits.
5. Use the dockplate to conduct loading and/or unloading operations. Beveled edges along the entry and exit edges provide smooth transitions from the loading dock surface and trailer bed onto the dockplate.
6. When loading/unloading operations are finished, and BEFORE the trailer drives away from the dock, remove the dockplate. Lift it using one of the side curbs and carry it to its designated indoor storage location. NOTE: An optional dockplate storage rack, [model DPR-2616](#), can be used for this purpose.

VII. RECORD OF SATISFACTORY CONDITION

Record the condition of the dockplate before putting it into service for the first time. Include observations about all features, including curbs, legs, tread plate, welds, bends, fasteners, and labels. Thoroughly photograph the unit so that all features are clearly imaged. Collect all writings, recordings, and photographs in a file. This file is a Record of the unit in satisfactory condition. During all future inspections, compare the condition of your dockplate to the Record to determine if the unit is in satisfactory condition. See section VIII. [INSPECTING & MAINTAINING THE DOCKPLATE](#) section below.

VIII. INSPECTING & MAINTAINING THE DOCKPLATE (ALL MODELS)

Inspections and repairs should only be performed by qualified persons. Compare the results of each inspection to the [RECORD OF SATISFACTORY CONDITION](#) (the "RECORD"). Do not use the dockplate unless all parts are in satisfactory condition. Replace parts that are not in satisfactory condition before using the dockplate again. DON'T GUESS! If you have any questions about the condition of your dockplate, speak with [TECHNICAL SERVICE](#) personnel. The phone number is provided on the cover page of this manual.

Never make temporary repairs of damaged or missing parts. Only use manufacturer-approved replacement parts.

Make a dated record of each inspection that includes a written account of your observations as well as a description of repairs made.

(A) Each day inspect the dockplate for the following conditions:

1. Visible damage to the plate, legs, or curbs.
2. Legs securely fastened to dockplate.
3. Any condition that can cause dockplate to be unstable during use.

(B) At least once per month, inspect the following components. DO NOT use the dockplate until it is restored to satisfactory condition.

1. Tread plate:
 - a) Inspect for wear, cracks, or other damage: If the plate is deformed or tread is worn, remove the dockplate from service and replace it.
 - b) Clean tread to maintain skid resistance.
2. Legs: Legs should be solidly fastened to the underside of the dockplate. Tighten loose fasteners. Check each leg for cracks, bends, warps, and for significant rusting/corrosion.
3. Curbs: Examine for damage (breaks, cracks, etc.) or looseness. Tighten loose fasteners.
4. Fasteners/hardware: Replace damaged/worn hardware. Any time a lock nut is loosened or removed from a bolt, it must be replaced with a new lock nut.
5. Welds and bends: Check for cracks, fatigue, and significant rust/corrosion.
6. Overall structure: Ensure no deformation; plate should be flat except for a single, designed bend.
7. Labels (refer to section X. [LABELING DIAGRAM](#) on p. 10): The dockplate should be labeled at all times as shown in the diagram. Replace any label that is damaged or not easily readable.

IX.A. EXPLODED VIEW AND BILLS OF MATERIALS: AHTD SERIES DOCK PLATES

11-006-010

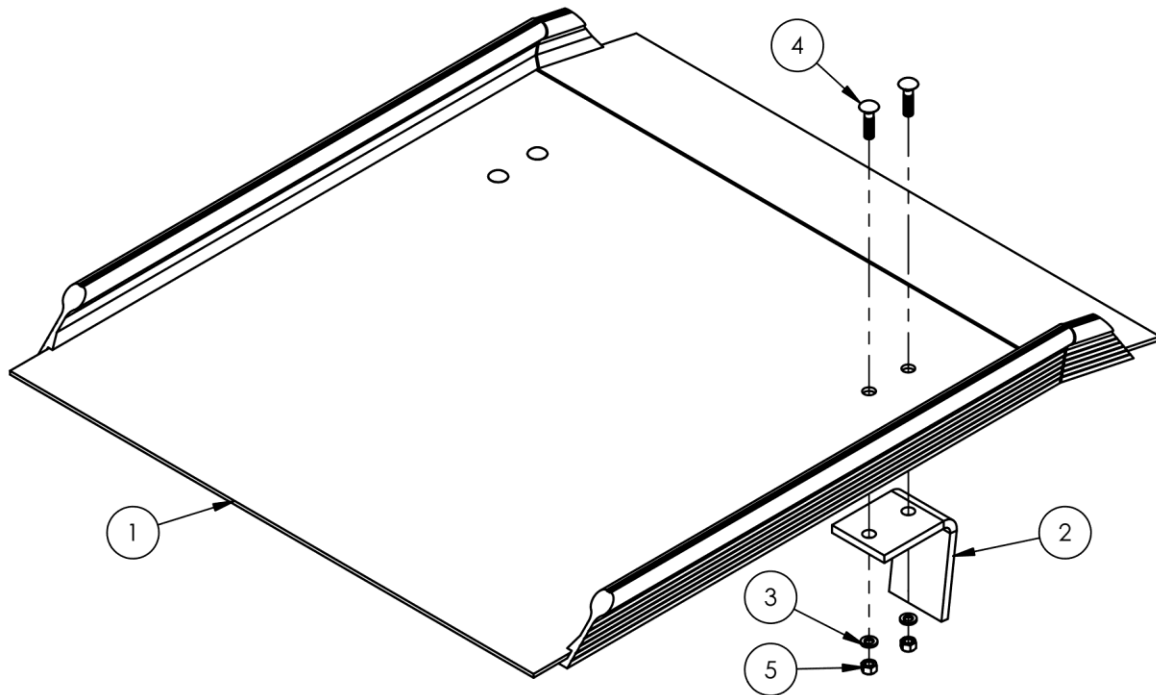

AHTD-series Aluminum Hand Truck Dockplates

Item	Part no.	Description	Qty.
1	11-514-028	DECK, ALUMINUM, FORMED, WITH SIDERAILS: AHTD-3036	1
	11-514-029	AHTD-3048	1
	11-514-032	AHTD-3648	1
	11-514-033	AHTD-3660	1
	11-514-034	AHTD-3672	1
	11-514-035	AHTD-3696	1
2	12-016-001	BRACKET, SUPPORT LEG, FORMED: AHTD-3036	1
	12-016-002	AHTD-3048	1
	12-016-002	AHTD-3648	1
	12-016-003	AHTD-3660	1
	12-016-004	AHTD-3672	1
	12-016-005	AHTD-3696	1
3	33622	3/8" SPLIT LOCK WASHER, CARBON STEEL, MEDIUM ZINC FINISH	4
4	21359	3/8" - 16UNC X 1 1/2", CARRIAGE BOLT, ZINC PLATED, GRADE A	4
5	36106	3/8" - 16 HEX NUT, GRADE A, ZINC PLATED	4

IX.B. EXPLODED VIEW: TAS SERIES DOCK PLATES (11-006-032)
BILLS OF MATERIALS ON FOLLOWING PAGE

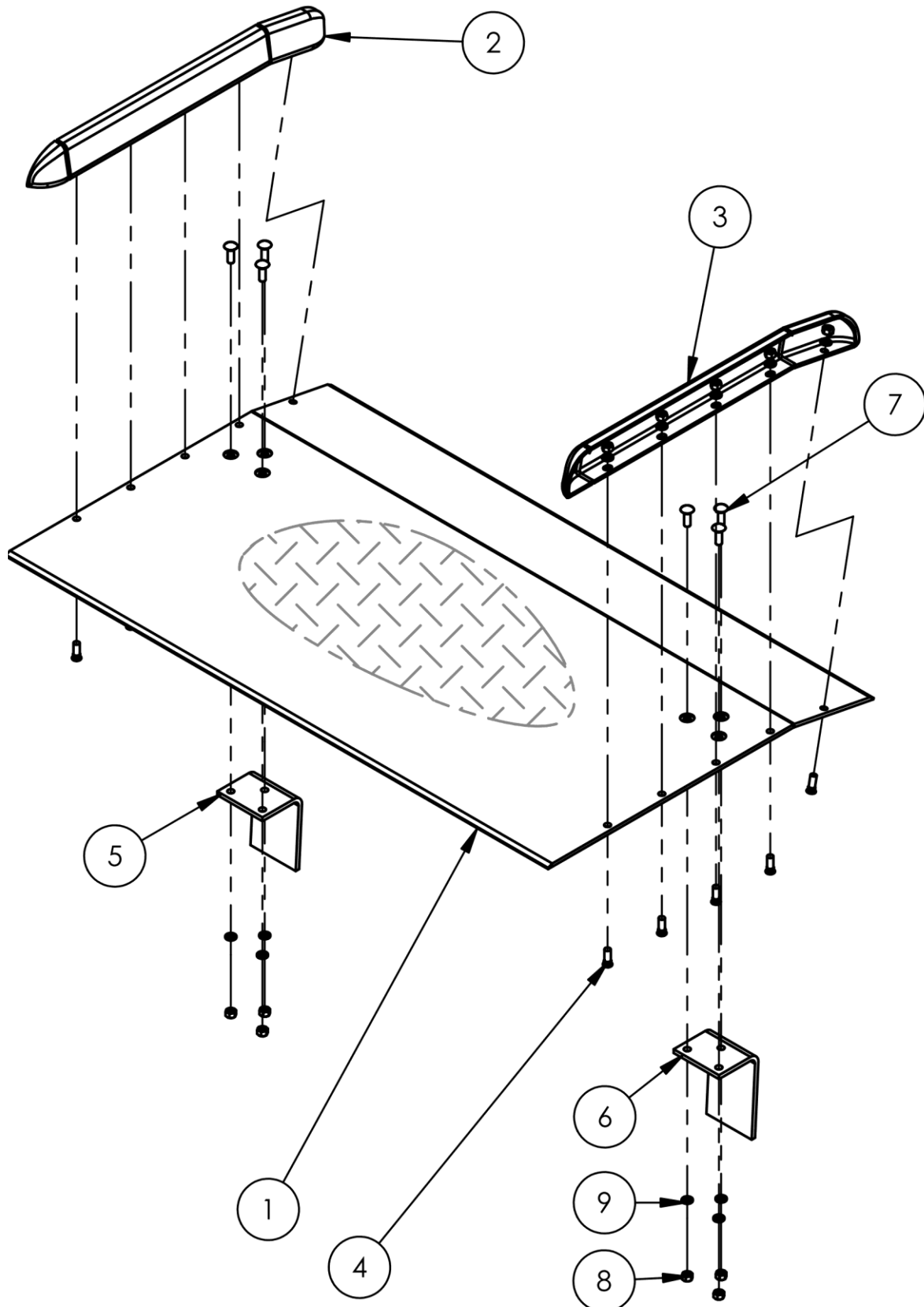

BILL OF MATERIALS FOR EXPLODED VIEW ON P. 8.

Item	Part no.	Description	Qty.	Item	Part no.	Description	Qty.
1		DECK PLATE, FORMED:		1		DECK PLATE, FORMED:	
	11-013-012	TAS-10-6036	1		11-013-205	TAS-15-7248	1
	11-013-016	TAS-10-6048	1		11-013-002	TAS-15-7260	1
	11-013-020	TAS-10-6060	1		11-013-014	TAS-20-6036	1
	11-013-011	TAS-10-6072	1		11-013-019	TAS-20-6048	1
	11-013-006	TAS-10-7236	1		11-013-021	TAS-20-6060	1
	11-013-005	TAS-10-7248	1		11-013-010	TAS-20-6072	1
	11-013-003	TAS-10-7260	1		11-013-007	TAS-20-7236	1
	11-013-014	TAS-15-6036	1		11-013-205	TAS-20-7248	1
	11-013-008	TAS-15-6048	1		11-013-002	TAS-20-7260	1
	11-013-021	TAS-15-6060	1		11-514-066	TAS-20-7272	1
	11-013-007	TAS-15-7236	1				
2		WELDMENT, LEFT SIDE, 3" CURB:					
	11-514-010	TAS-10-6036; TAS-10-7236; TAS-15-6036; TAS-15-7236	1				
	11-514-024	TAS-10-6048; TAS-10-7248	1				
	11-514-026	TAS-10-6060;	1				
	11-514-017	TAS-10-6072	1				
		WELDMENT, LEFT SIDE CURB, 4"					
	11-514-018	TAS-10-7260; TAS-15-6060; TAS-15-7260	1				
	11-514-012	TAS-15-6048; TAS-15-7248; TAS-20-6048; TAS-20-7248	1				
	11-514-022	TAS-20-6036; TAS-20-7236	1				
	11-514-040	TAS-20-6060; TAS-20-7260	1				
	11-514-038	TAS-20-6072; TAS-20-7272	1				
3		WELDMENT, RIGHT SIDE, 3" CURB:					
	11-514-011	TAS-10-6036; TAS-10-7236; TAS-15-6036; TAS-15-7236	1				
	11-514-023	TAS-10-6048; TAS-10-7248	1				
	11-514-025	TAS-10-6060	1				
	11-514-016	TAS-10-6072	1				
		WELDMENT, RIGHT SIDE CURB, 4"					
	11-514-015	TAS-10-7260; TAS-15-6060; TAS-15-7260	1				
	11-514-013	TAS-15-6048; TAS-15-7248; TAS-20-6048; TAS-20-7248	1				
	11-514-021	TAS-20-6036; TAS-20-7236	1				
	11-514-039	TAS-20-6060; TAS-20-7260	1				
	11-514-037	TAS-20-6072; TAS-20-7272	1				
4		PIN, MACHINE STUD, 1/2"-13					
		TAS-10-6036; TAS-10-7236; TAS-15-6036; TAS-15-7236; TAS-20-6036; TAS-20-7236	10				
	11-112-001	TAS-10-6048; TAS-10-7248; TAS-15-6048; TAS-15-7248; TAS-20-6048; TAS-20-7248	14				
		TAS-10-6060; TAS-10-7260; TAS-15-6060; TAS-15-7260; TAS-20-6060; TAS-20-7260	18				
		TAS-10-6072; TAS-20-6072; TAS-20-7272	22				
5		BRACKET/LEG, FORMED:					
	12-016-010	7": TAS-10-6036; TAS-10-7236; TAS-15-6036; TAS-15-7236; TAS-20-6036; TAS-20-7236	1				
	12-016-011	8": TAS-10-6048; TAS-10-7248; TAS-15-6048; TAS-15-7248; TAS-20-6048; TAS-20-7248	1				
	12-016-013	11": TAS-10-6060; TAS-15-6060; TAS-15-7260; TAS-20-6060; TAS-20-7260	1				
	12-016-015	14": TAS-10-6072; TAS-20-6072; TAS-20-7272	1				
6		BRACKET/LEG, FORMED:					
	12-016-011	8": TAS-10-6036; TAS-10-7236; TAS-15-6036; TAS-15-7236; TAS-20-6036; TAS-20-7236	1				
	12-016-008	9": TAS-10-6048; TAS-10-7248; TAS-15-6048; TAS-15-7248; TAS-20-6048; TAS-20-7248	1				
	12-016-014	13": TAS-10-6060; TAS-15-6060; TAS-15-7260; TAS-20-6060; TAS-20-7260	1				
	12-016-009	12": TAS-10-6072; TAS-20-6072; TAS-20-7272	1				
7	20268	CARRIAGE BOLT, 1/2"-13 X 1 1/2"	6				
8		HEX NUT, Z-PLATED, GRADE A, 1/2"-13					
		TAS-10-6036; TAS-10-7236; TAS-15-6036; TAS-15-7236; TAS-20-6036; TAS-20-7236	16				
	36110	TAS-10-6048; TAS-10-7248; TAS-15-6048; TAS-15-7248; TAS-20-6048; TAS-20-7248	20				
		TAS-10-6060; TAS-10-7260; TAS-15-6060; TAS-15-7260; TAS-20-6060; TAS-20-7260	24				
		TAS-10-6072; TAS-20-6072; TAS-20-7272	28				
9		LOCK WASHER, Z-PLATED, 1/2"					
		TAS-10-6036; TAS-10-7236; TAS-15-6036; TAS-15-7236; TAS-20-6036; TAS-20-7236	16				
	33626	TAS-10-6048; TAS-10-7248; TAS-15-6048; TAS-15-7248; TAS-20-6048; TAS-20-7248	20				
		TAS-10-6060; TAS-10-7260; TAS-15-6060; TAS-15-7260; TAS-20-6060; TAS-20-7260	24				
		TAS-10-6072; TAS-20-6072; TAS-20-7272	28				



XI. LIMITED WARRANTY

Vestil Manufacturing Company ("Vestil") warrants this product to be free of defects in material and workmanship during the warranty period. Our warranty obligation is to provide a replacement for a defective, original part covered by the warranty after we receive a proper request from the Warrantee (you) for warranty service.

Who may request service?

Only a warrantee may request service. You are a warrantee if you purchased the product from Vestil or from an authorized distributor AND Vestil has been fully paid.

Definition of "original part"?

An original part is a part used to make the product as shipped to the Warrantee.

What is a "proper request"?

A request for warranty service is proper if Vestil receives: 1) a photocopy of the Customer Invoice that displays the shipping date; AND 2) a written request for warranty service including your name and phone number. Send requests by one of the following methods:

US Mail
Vestil Manufacturing Company
2999 North Wayne Street, PO Box 507
Angola, IN 46703

Fax
(260) 665-1339
Phone
(260) 665-7586

Email
info@vestil.com
Enter "Warranty service request"
in subject field.

In the written request, list the parts believed to be defective and include the address where replacements should be delivered. After Vestil receives your request for warranty service, an authorized representative will contact you to determine whether your claim is covered by the warranty. Before providing warranty service, Vestil will require you to send the entire product, or just the defective part (or parts), to its facility in Angola, IN.

What is covered under the warranty?

The warranty covers defects in the following original, dynamic parts: motors, hydraulic pumps, motor controllers, and cylinders. It also covers defects in original parts that wear under normal usage conditions ("wearing parts"), such as bearings, hoses, wheels, seals, brushes, and batteries.

How long is the warranty period?

The warranty period for original dynamic components is 90 days. For wearing parts, the warranty period is 90 days. Both warranty periods begin on the date Vestil ships the product to the Warrantee. If the product was purchased from an authorized distributor, the periods begin when the distributor ships the product. Vestil may, at its sole discretion, extend a warranty period for products shipped from authorized distributors by up to 30 days to account for shipping time.

If a defective part is covered by the warranty, what will Vestil do to correct the problem?

Vestil will provide an appropriate replacement for any covered part. An authorized representative of Vestil will contact you to discuss your claim.

What is not covered by the warranty?

The Warrantee (you) are responsible for paying labor costs and freight costs to return the product to Vestil for warranty service.

Events that automatically void this Limited Warranty.

- Misuse;
- Negligent assembly, installation, operation or repair;
- Installation/use in corrosive environments;
- Inadequate or improper maintenance;
- Damage sustained during shipping;
- Collisions or other accidents that damage the product;
- Unauthorized modifications: Do not modify the product IN ANY WAY without first receiving written authorization from Vestil.

Do any other warranties apply to the product?

Vestil Manufacturing Co. makes no other express warranties. All implied warranties are disclaimed to the extent allowed by law. Any implied warranty not disclaimed is limited in scope to the terms of this Limited Warranty. Vestil makes no warranty or representation that this product complies with any state or local design, performance, or safety code or standard. Noncompliance with any such code or standard is not a defect in material or workmanship.